

# Hydraulic Clamp Nut

## Piston system



Series 010 / 110

### Features of series

**Axial operating  
with Allen key**

**Medium remains into the system**



The actuator screws has to be turned into the body by using the enclosed Allen key.  
The internal medium will flow into the circular groove and raise the ring piston.  
With less manual force you create a big hydraulic clamping force.  
For to relieve the clamp nut put the actuator screws to the start position  
and move the nut to the opposite direction.  
The medium remains into the system.

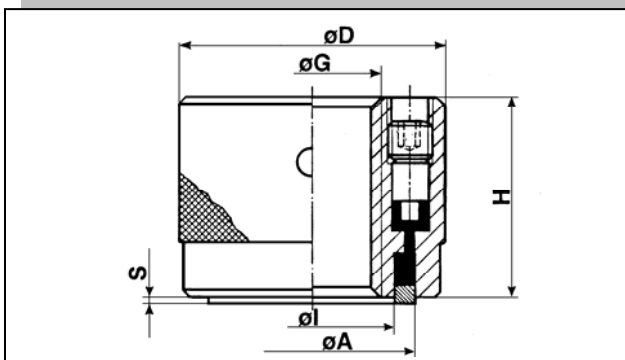

**Clamping range 2 mm**

Thread	Ring piston		Outer Diameter	Height	Clamping force (achieved by hand)	Part No Clamping range S 2 mm
$\sigma G_{max.}$	$\sigma A$	$\sigma I$	$\sigma D$	H	in kN	
16	28	22	44	40	25	<b>110.02.016</b>
20	34	26	48	47	40	<b>110.02.020</b>
24	40	32	56	47	40	<b>110.02.024</b>
30	46	38	63	48	50	<b>110.02.030</b>
36	52	44	70	50	55	<b>010.02.036</b>
42	62	50	80	60	95	<b>010.02.042</b>
52	72	60	90	60	110	<b>010.02.052</b>
68	92	82	110	60	120	<b>010.02.068</b>
80	100	88	120	70	160	<b>010.02.080</b>
100	125	110	145	80	190	<b>010.02.100</b>

Against corrosion our hydraulic clamp nuts are protected with a brown finish.  
The standard sealing systems are suitable for temperatures up to 80°.  
The ring piston is locked against drop out.

Special design of hydraulic clamp nuts on request



AVEMAR CZECH s.r.o. | speciální armatury pro měření a regulaci  
Branch office | Lihovarská 1199/10 | 716 03 Ostrava - Radvanice | Česká republika  
Tel.: +420 596 232 996 (7) | Fax: +420 596 232 998 | www.avemar.cz | avemar@avemar.cz